

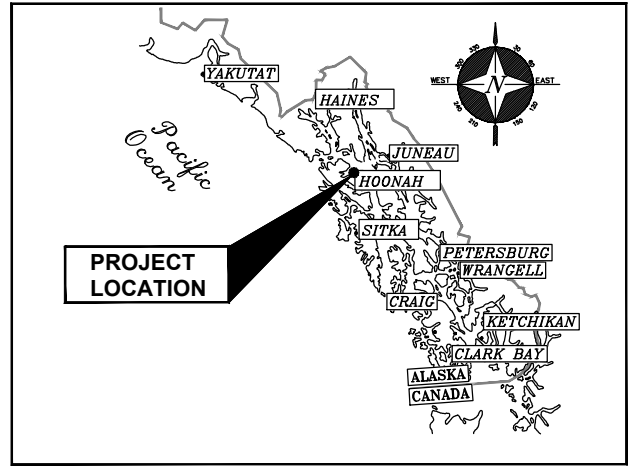

KEY MAP



LOCATION MAP

HOONAH HARBOR WAY PEDESTRIAN IMPROVEMENTS & PITT ISLAND CEMETERY	
TOTAL FILL AREA BELOW HTL =	0.1717 Acre
TOTAL FILL VOLUME BELOW HTL (EMBANKMENT + RIPRAP) =	2,019 Cu.Yd.
TOTAL RIPRAP VOLUME BELOW HTL =	754 Cu.Yd.
SEE SHEET 7 FOR TEMPORARY FILL	

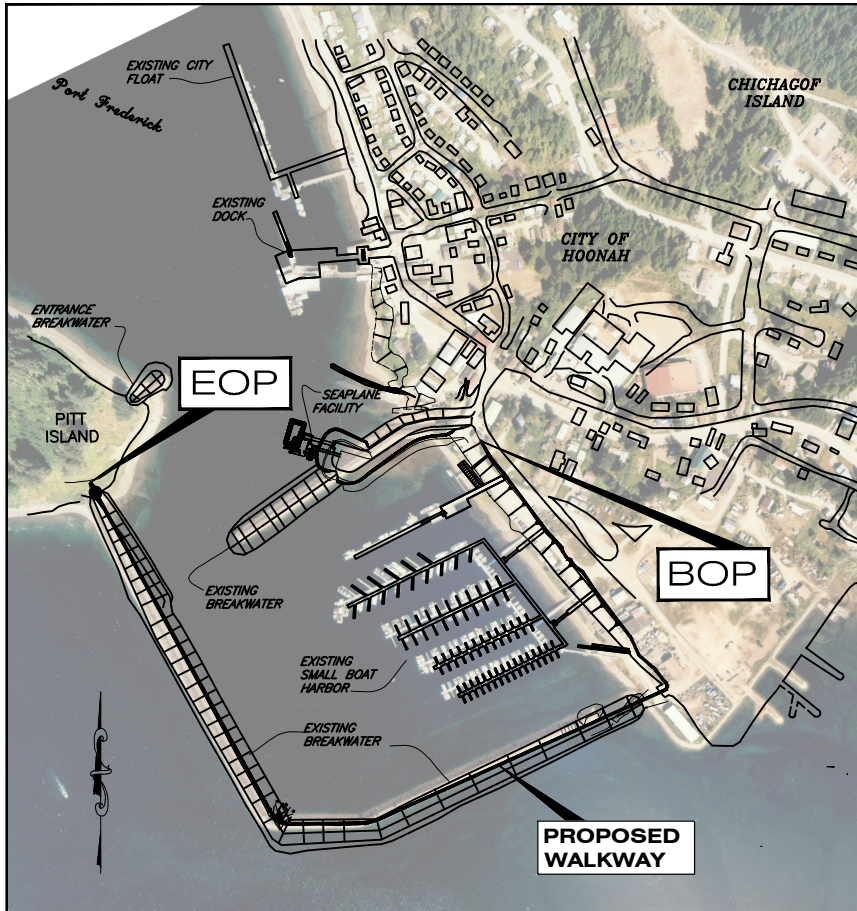

VICINITY MAP

SHEET INDEX	
SHEET:	DESCRIPTION
1	COVER SHEET
2	OVERALL SITE PLAN
3	WALKWAY TYPICAL SECTION, EOP TRANSITION
4	BREAKWATER WIDENING AT BRIDGE ABUTMENT
5	BREAKWATER WALKWAY WIDENING
6	PEDESTRIAN BRIDGE
7	TEMPORARY ACCESS AT BRIDGE ABUTMENT
8	TEMPORARY ACCESS AT BREAKWATER WIDENING

<i>TIDAL DATA</i>	
HTL:	+19.3'
MHW:	+13.9'
MLLW:	0.0'
ELW:	-5.0'

WATER BODIES: Port Frederick

PROJECT LOCATION: Township (T) 43 S, Range (R) 61 E, Section (S) 30, USGS Quadrangle Juneau A-5, Copper River Meridian.

KEY AND REGIONAL MAPS

APPLICATION BY:
ALASKA STATE DEPT. OF TRANSPORTATION AND PUBLIC FACILITIES
SOUTHCOAST REGION

HNH HARBOR WAY PEDESTRIAN IMP & PITT ISLAND CEMETERY WALKWAY PROJECT NO. 0003255\SFHWY00278

AT: HOONAH, ALASKA
LOCATED IN: Hoonah, AK.

DATE: April 28, 2022

SHEET 1 **OF** 7

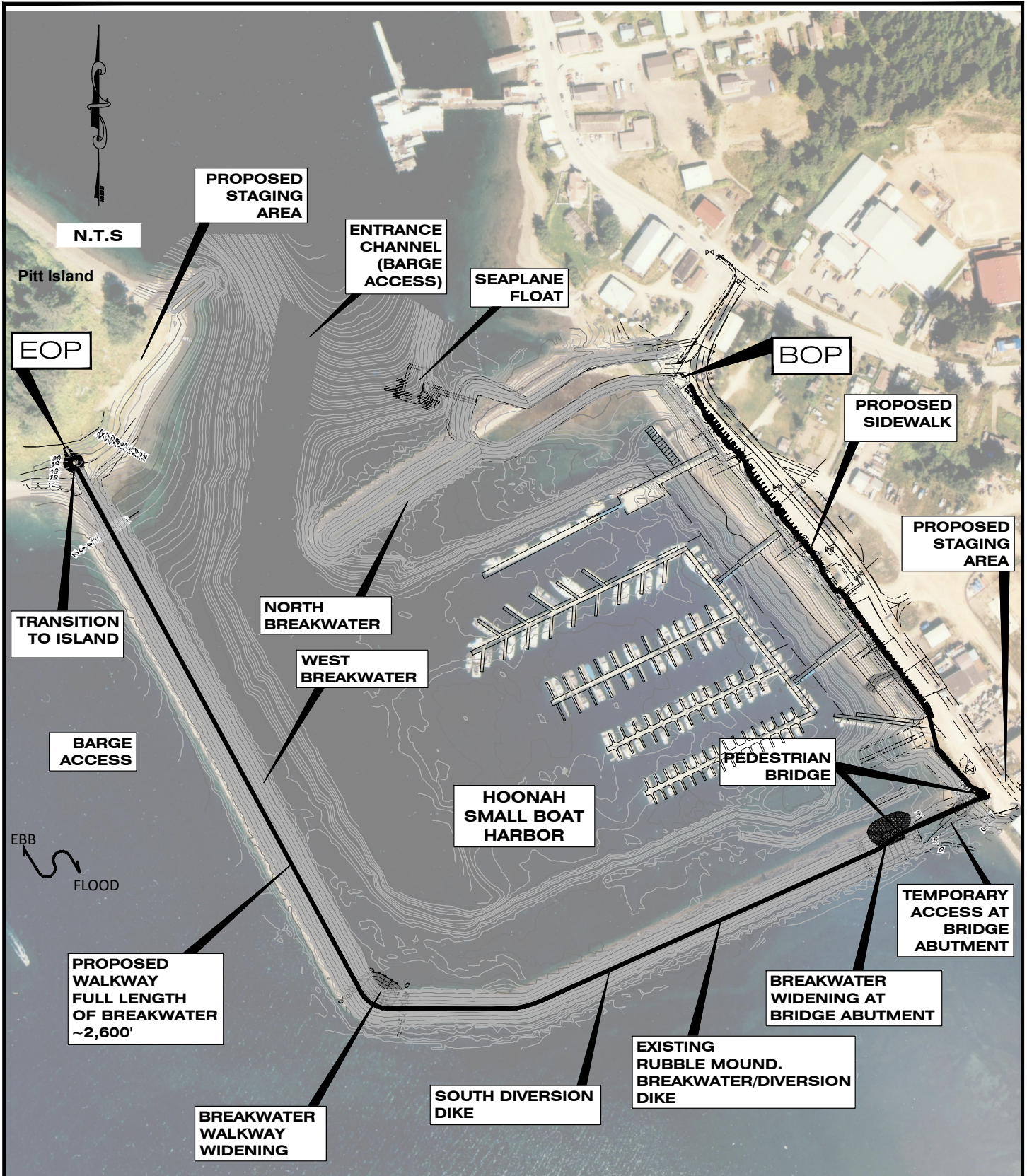

ADJACENT PROPERTY OWNERS:
 City of Hoonah Alf R. Skaflestad
 State of Alaska Seferine Villarreal
 Huna Totem Corporation

WATER BODIES: Port Frederick
PROJECT LOCATION: Township (T) 43 S,
 Range (R) 61 E, Section (S) 30, USGS
 Quadrangle Juneau A-5, Copper River
 Meridian.

**OVERALL
 SITE PLAN**
 APPLICATION BY:
 ALASKA STATE DEPT. OF TRANSPORTATION
 AND PUBLIC FACILITIES
 SOUTHCOAST REGION

**HNH HARBOR WAY PEDESTRIAN IMP &
 PITT ISLAND CEMETERY WALKWAY**
 PROJECT NO. 0003255/SFHWY00278
 AT: HOONAH, ALASKA
 LOCATED IN: Hoonah, AK.
 DATE: April 28, 2022 SHEET 2 OF 7

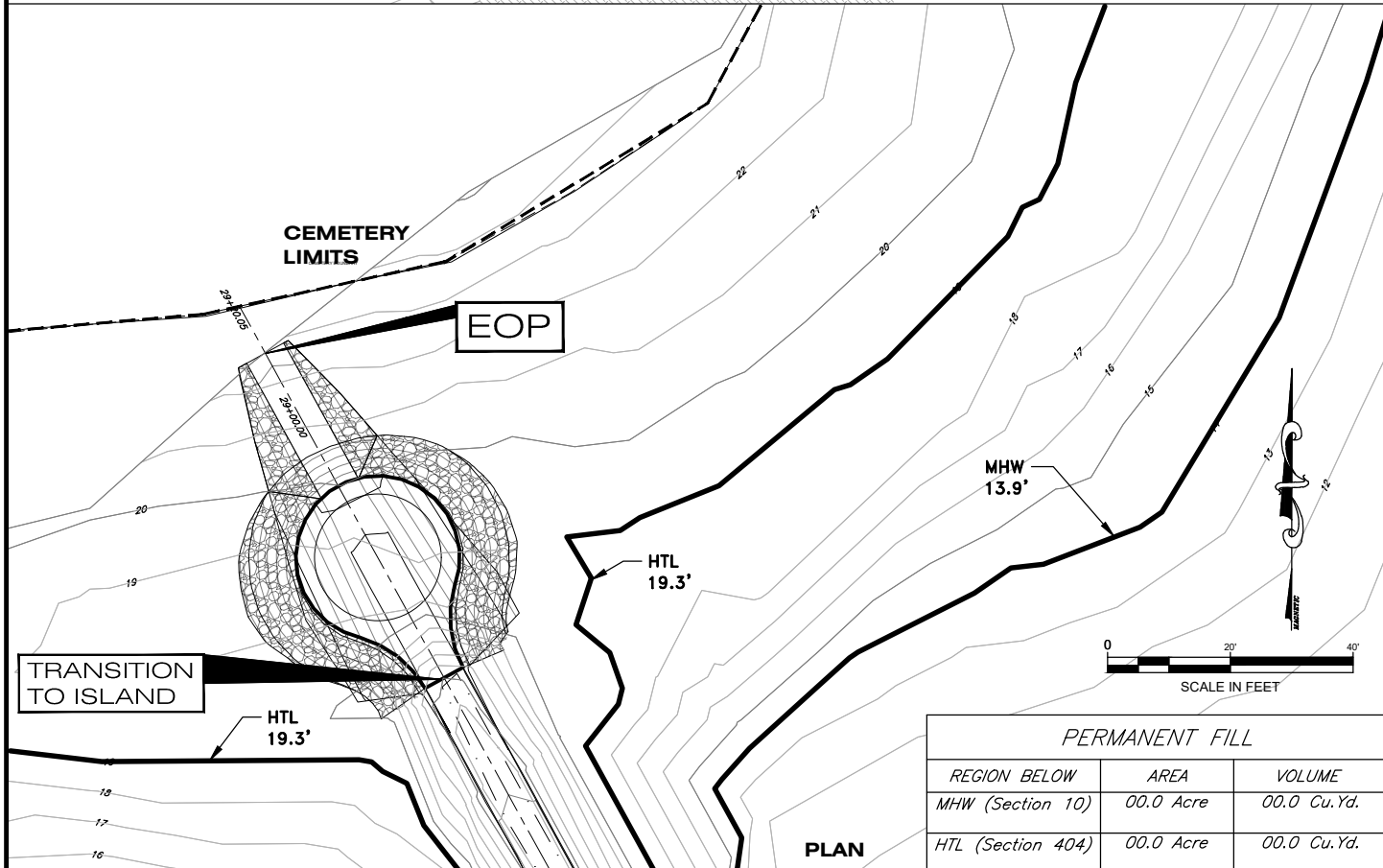
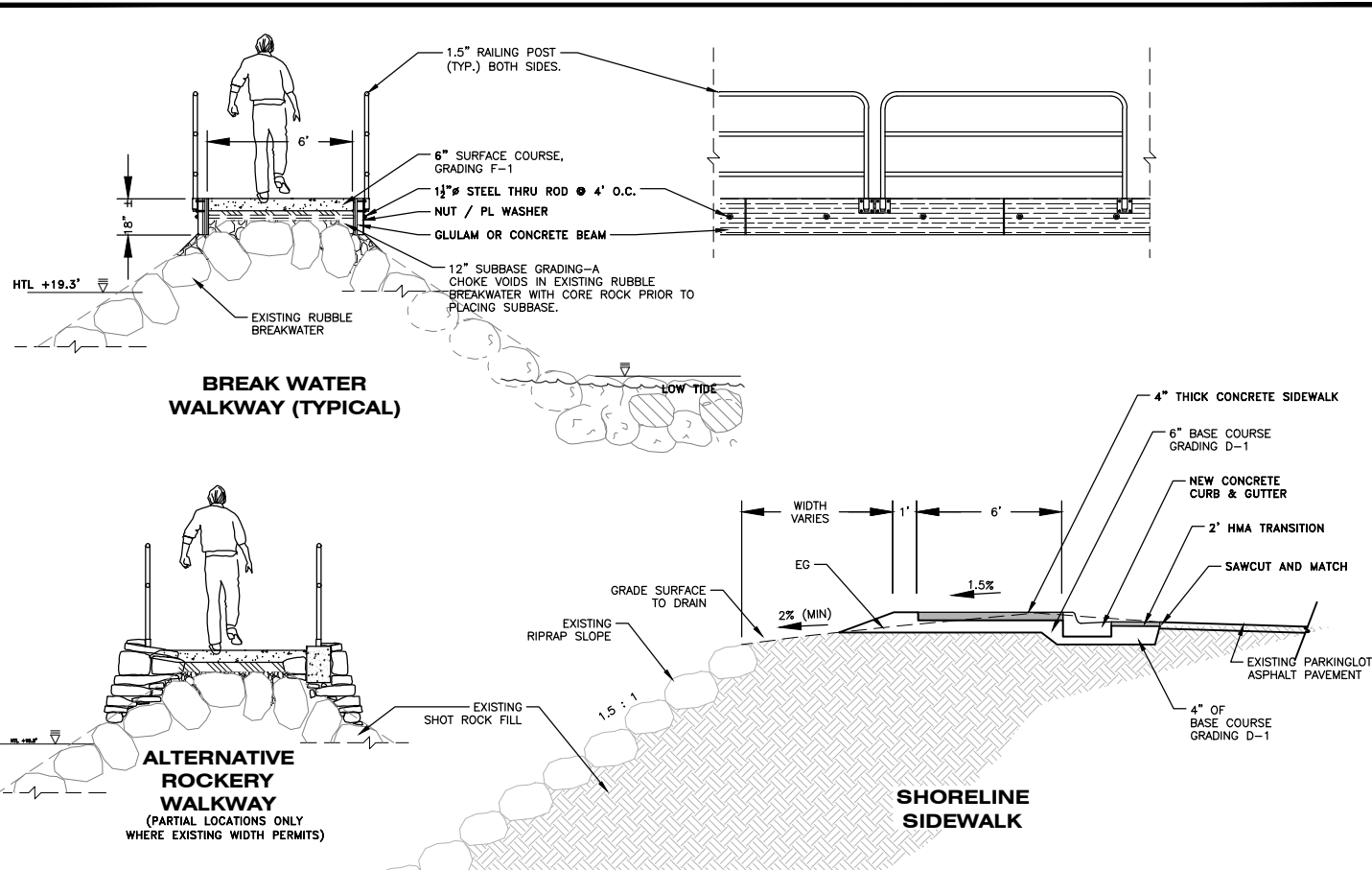

PERMANENT FILL		
REGION BELOW	AREA	VOLUME
MHW (Section 10)	00.0 Acre	00.0 Cu.Yd.
HTL (Section 404)	00.0 Acre	00.0 Cu.Yd.

WATER BODIES: Port Frederick
 PROJECT LOCATION: Township (T) 43 S, Range (R) 61 E, Section (S) 30, USGS Quadrangle Juneau A-5, Copper River Meridian.

WALKWAY TYPICAL SECTION, EOP TRANSITION
 APPLICATION BY:
 ALASKA STATE DEPT. OF TRANSPORTATION AND PUBLIC FACILITIES
 SOUTHCOAST REGION

HNH HARBOR WAY PEDESTRIAN IMP & PITT ISLAND CEMETERY WALKWAY
 PROJECT NO. 0003255\SFHWY00278
 AT: HOONAH, ALASKA
 LOCATED IN: Hoonah, AK.
 DATE: April 28, 2022 SHEET 3 OF 7

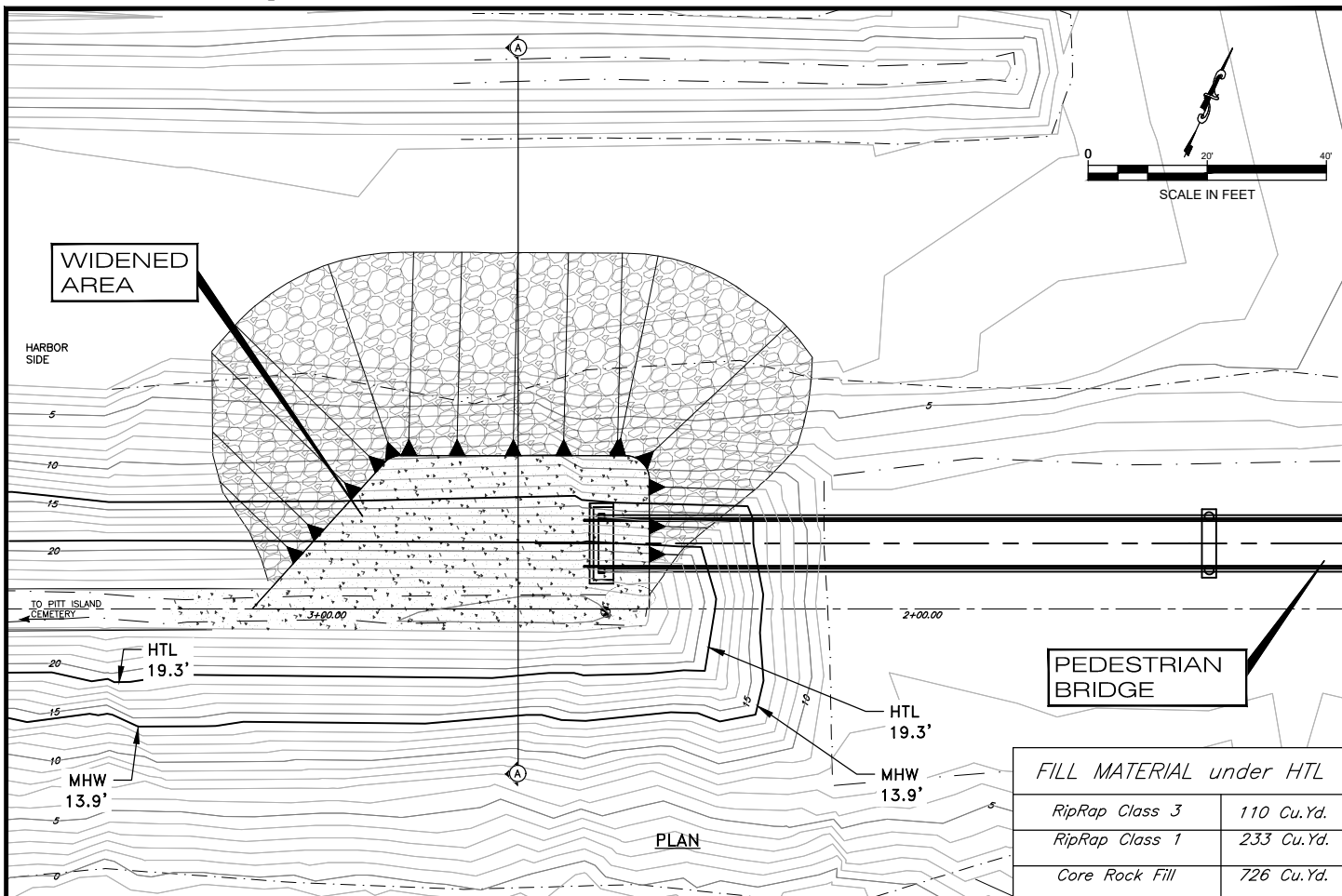

FILL MATERIAL under HTL	
RipRap Class 3	110 Cu.Yd.
RipRap Class 1	233 Cu.Yd.
Core Rock Fill	726 Cu.Yd.

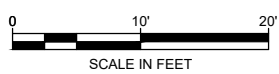

PERMANENT FILL		
REGION BELOW	AREA	VOLUME
MHW (Section 10)	0.099 Acre	769 Cu.Yd.
HTL (Section 404)	0.087 Acre	1,069 Cu.Yd.

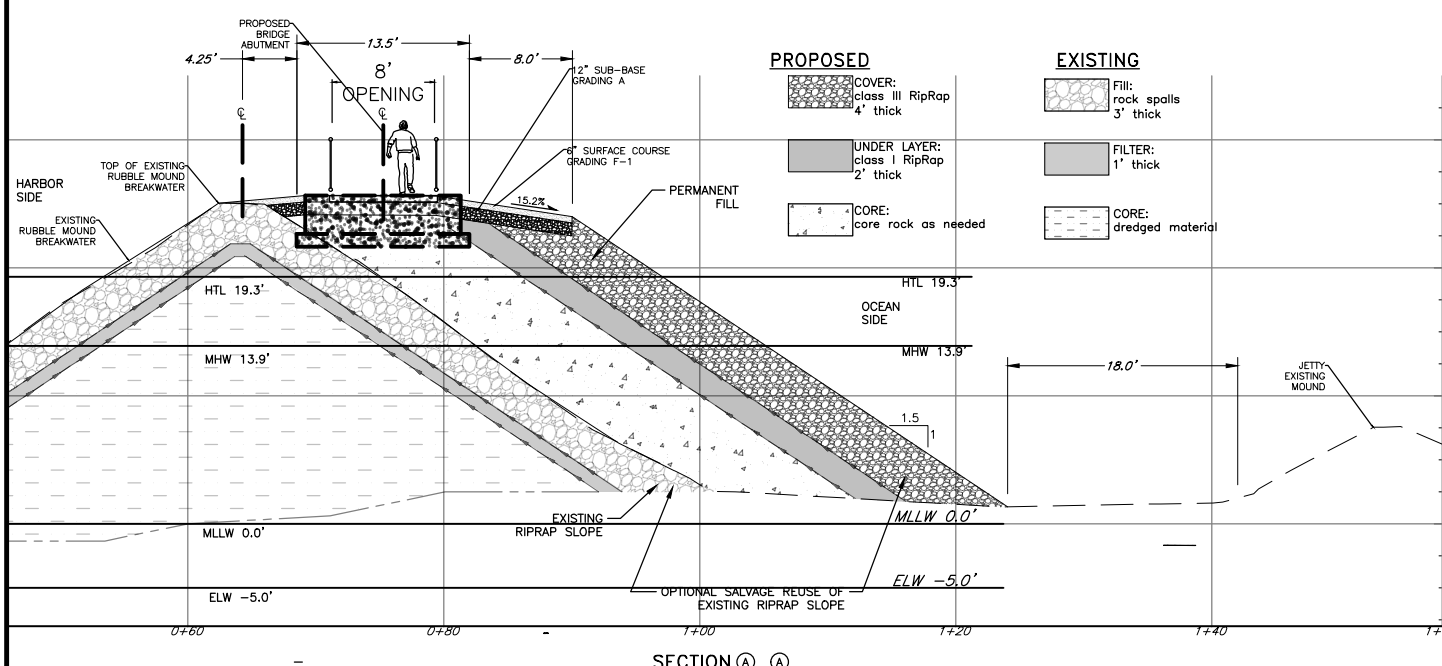

PROPOSED	EXISTING
COVER: class III RipRap 4' thick	Fill: rock spalls 3' thick
UNDER LAYER: class I RipRap 2' thick	FILTER: 1' thick
CORE: core rock as needed	CORE: dredged material

SECTION A-A

WATER BODIES: Port Frederick
PROJECT LOCATION: Township (T) 43 S, Range (R) 61 E, Section (S) 30, USGS Quadrangle Juneau A-5, Copper River Meridian.

BREAKWATER WIDENING AT BRIDGE ABUTMENT
 APPLICATION BY:
 ALASKA STATE DEPT. OF TRANSPORTATION AND PUBLIC FACILITIES
 SOUTHCOAST REGION

HNH HARBOR WAY PEDESTRIAN IMP & PITT ISLAND CEMETERY WALKWAY
 PROJECT NO. 0003255\FHWY00278
 AT: HOONAH, ALASKA
 LOCATED IN: Hoonah, AK.
 DATE: April 28, 2022 SHEET 4 OF 7

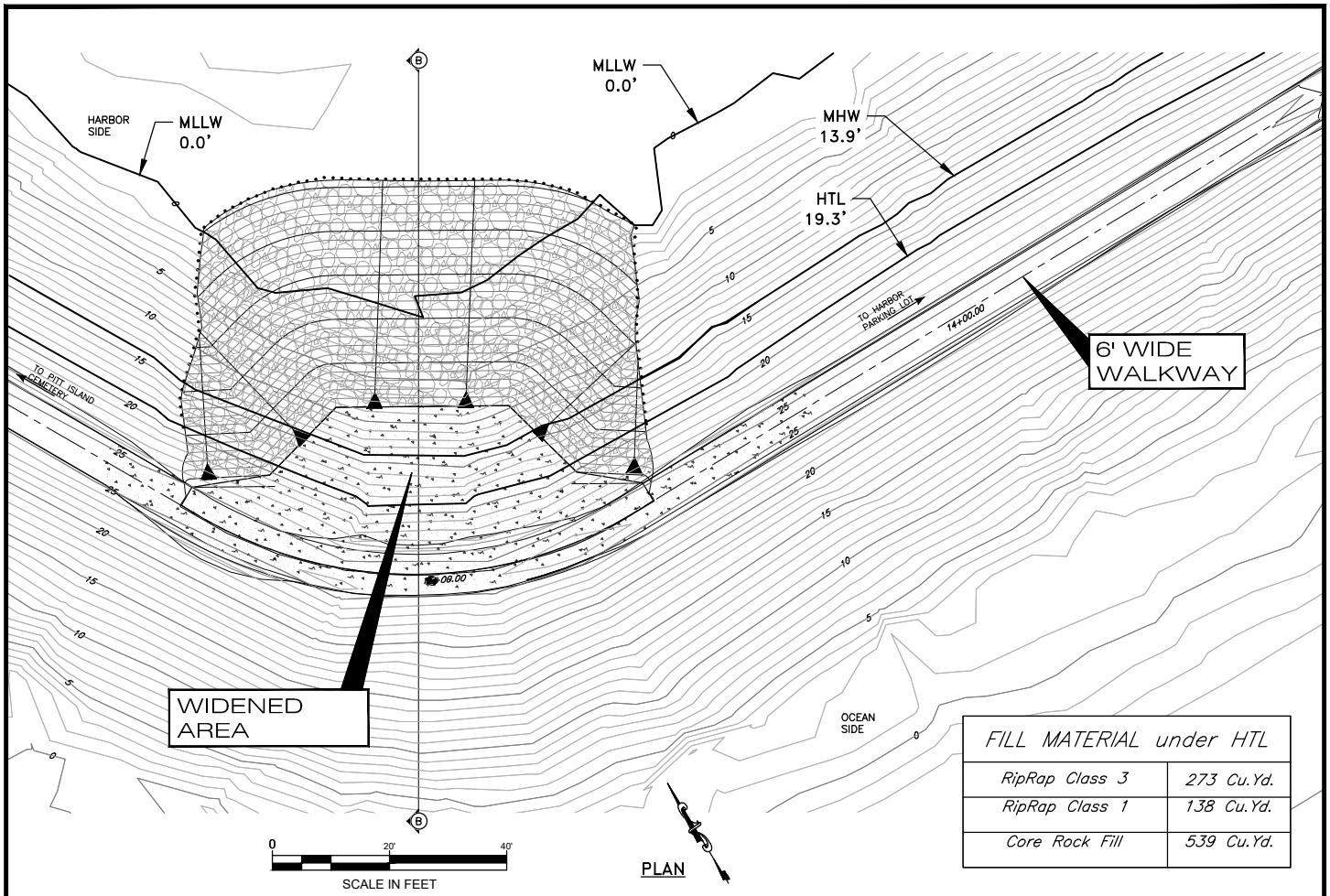

FILL MATERIAL under HTL	
RipRap Class 3	273 Cu.Yd.
RipRap Class 1	138 Cu.Yd.
Core Rock Fill	539 Cu.Yd.

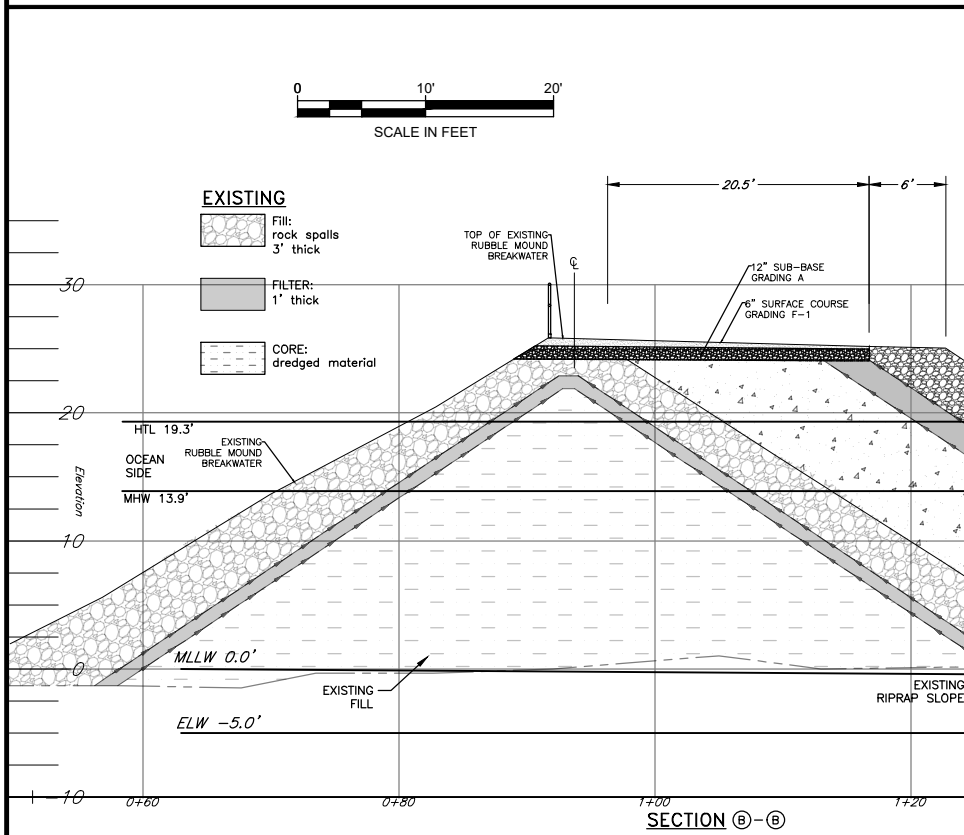

PERMANENT FILL		
REGION BELOW	AREA	VOLUME
MHW (Section 10)	0.0704 Acre	694 Cu.Yd.
HTL (Section 404)	0.0847 Acre	950 Cu.Yd.

WATER BODIES: Port Frederick
PROJECT LOCATION: Township (T) 43 S, Range (R) 61 E, Section (S) 30, USGS Quadrangle Juneau A-5, Copper River Meridian.

BREAKWATER WALKWAY WIDENING
 APPLICATION BY:
 ALASKA STATE DEPT. OF TRANSPORTATION AND PUBLIC FACILITIES
 SOUTHCOAST REGION

HNH HARBOR WAY PEDESTRIAN IMP & PITT ISLAND CEMETERY WALKWAY
 PROJECT NO. 0003255\FHWY00278
 AT: HOONAH, ALASKA
 LOCATED IN: Hoonah, AK.
 DATE: April 28, 2022 SHEET 5 OF 7

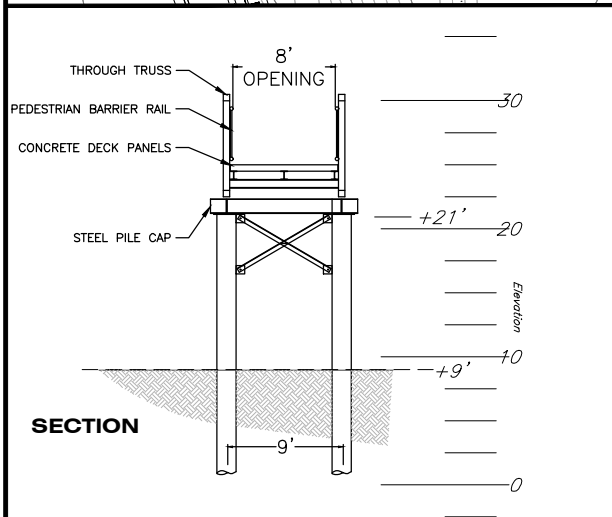
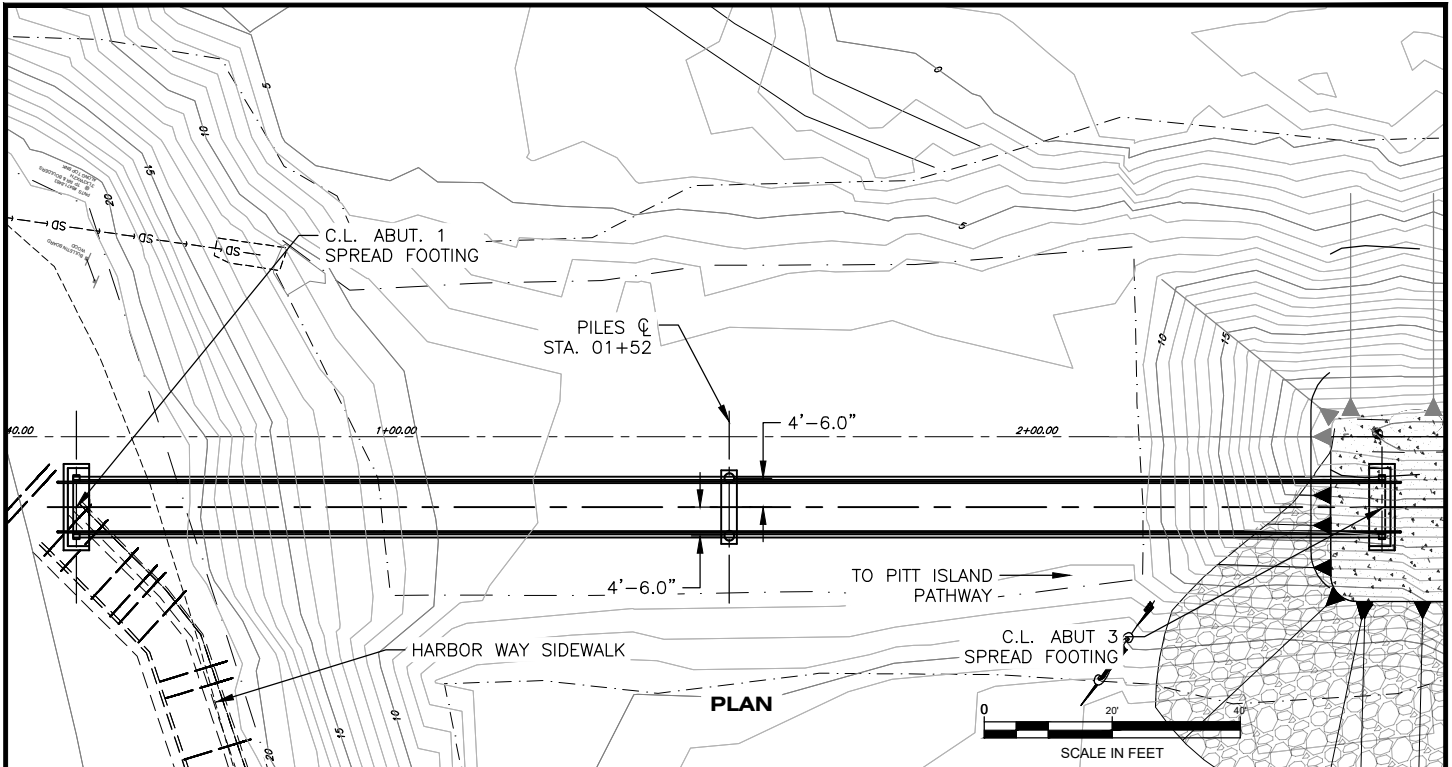

PILE DATA						
STRUCTURE	REMOVE EXISTING STEEL PIPE PILE (DIA)	NO. REQUIRED	NEW STEEL PIPE PILE (DIA)	NO. REQUIRED	DRILLED ROCK SOCKET (EA)	DRILLED PILE TENSION ANCHOR (EA)
PEDESTRIAN BRIDGE PIER 2	N/A	N/A	18"	2	N/A	2
TEMPORARY PILES	N/A	N/A	18"	4	0	0

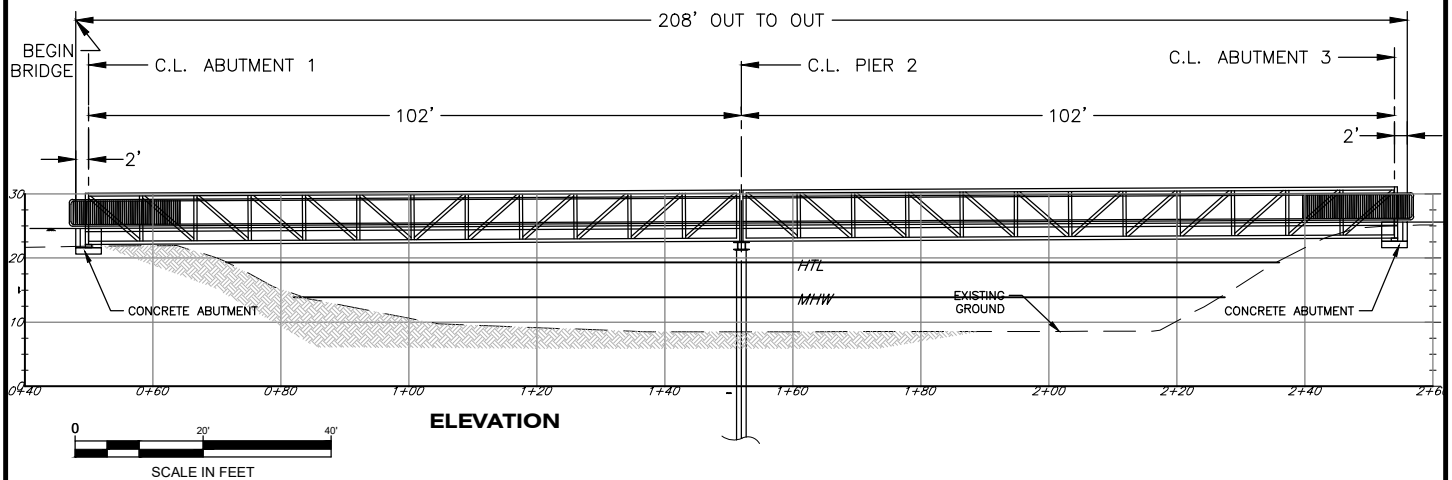

WATER BODIES: Port Frederick
PROJECT LOCATION: Township (T) 43 S, Range (R) 61 E, Section (S) 30, USGS Quadrangle Juneau A-5, Copper River Meridian.

PEDESTRIAN BRIDGE
 APPLICATION BY:
 ALASKA STATE DEPT. OF TRANSPORTATION AND PUBLIC FACILITIES
 SOUTHCOAST REGION

HNH HARBOR WAY PEDESTRIAN IMP & PITT ISLAND CEMETERY WALKWAY
 PROJECT NO. 0003255/SFHWY00278
 AT: HOONAH, ALASKA
 LOCATED IN: Hoonah, AK.
 DATE: April 28, 2022 SHEET 6 OF 7

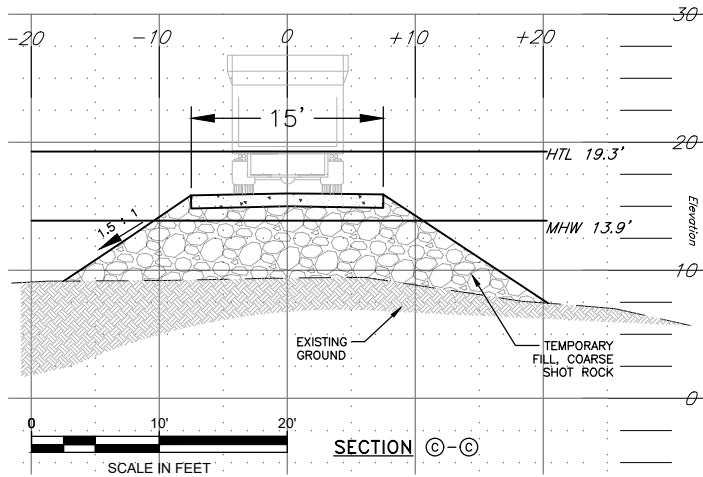
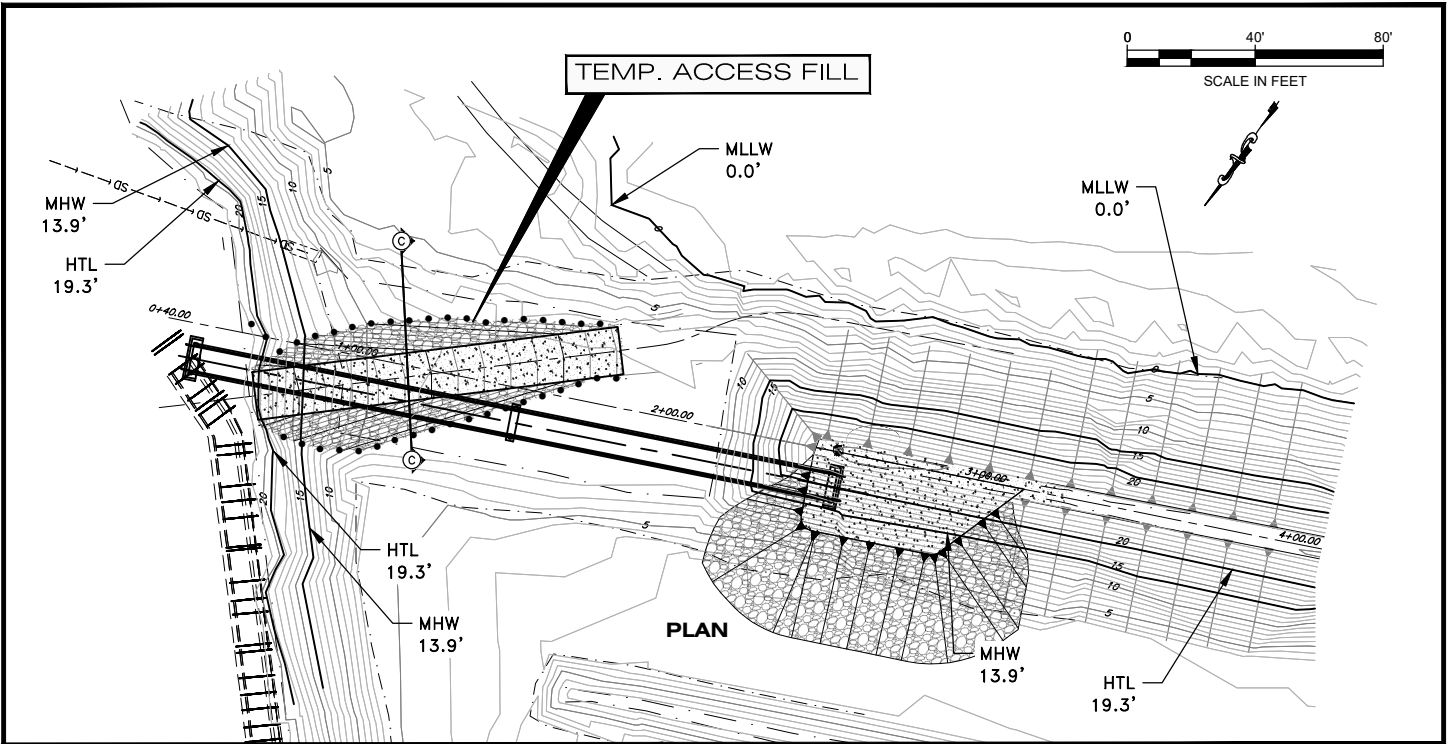

TEMPORARY FILL		
REGION BELOW	AREA	VOLUME
MHW (Section 10)	0.1014 Acre	479 Cu.Yd.
HTL (Section 404)	0.1105 Acre	724 Cu.Yd.

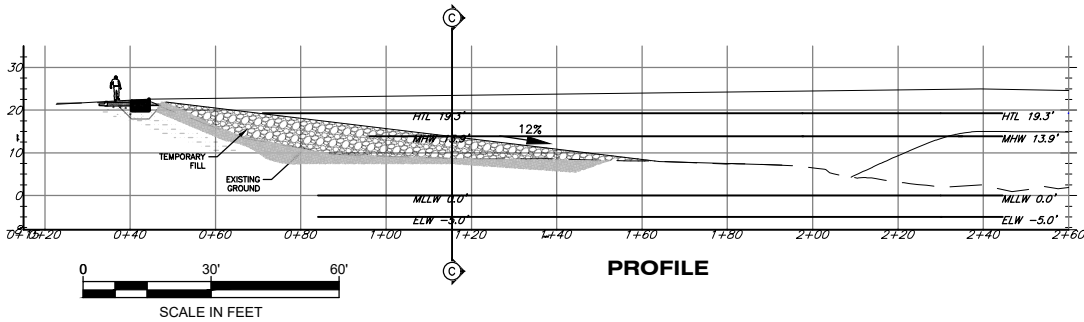

WATER BODIES: Port Frederick

PROJECT LOCATION: Township (T) 43 S,
Range (R) 61 E, Section (S) 30, USGS
Quadrangle Juneau A-5, Copper River
Meridian.

**TEMPORARY ACCESS
AT BRIDGE ABUTMENT**

APPLICATION BY:
ALASKA STATE DEPT. OF TRANSPORTATION
AND PUBLIC FACILITIES
SOUTHCOAST REGION

HNH HARBOR WAY PEDESTRIAN IMP &
PITT ISLAND CEMETERY WALKWAY
PROJECT NO. 0003255\FHWY00278

AT: HOONAH, ALASKA
LOCATED IN: Hoonah, AK.

DATE: April 28, 2022

SHEET 7 OF 7